



Features:

Isolation Class II

Protection: Short circuit, Overload, Over voltage

Cooling by free air convection

Can be installed on DIN rail TS-35/7.5 or 15

LED indicator for power on

100% full load burn-in test

2 years warranty



Specification

Model		PT-60-12	PT-60-24
Output	DC Voltage	12V	24V
	Rated Current	5A	2.5A
	Current Range	0~5A	0~2.5A
	Rated Power	60W	60W
	Ripple&Noise	120 mVp-p	150 mVp-p
	Voltage Adj.Range	10.8-13.6V	21.6-29.0V
	Hold Up Time	100ms/230VAC	
	Set up,Rise time	500ms, 20ms / 230VAC	
Input	Voltage Range	170-265 VAC 47~63Hz	
	Efficiency	85%	86%
	Ac Current	0.5A/230VAC	
	Inrush Current	Cold Start <40A at 230VAC	
Protection	Over Current	110~160% rated output power	
	Protection Type	Hiccup mode, recovers automatically after fault condition is removed	
	Over Voltage	Hiccup mode, recovers automatically after fault condition is removed	
Environment	WorkingTemp&Humidity	-20-60°C 20-90% RH	
	StorageTemp&Humidity	-40-80°C 10-90%RH	
Safety&EMC	Safety Standards	Design Refer to: EN60950	
	Withstand Voltage	I/P-O/P:3KVAC	
	Isolation Resistance	I/P-O/P:>100M Ohms / 500VDC	
	EMC Emission	Compliance to EN55022 , EN61000-3-2 ,	
	EMC Immunity	Compliance to EN55024, EN61000-3-3,	
Others	Dimension	78*97*56mm (W*H*D)	
	Packing	0.27 kg/pcs 50pcs/14.5kg/ctn	

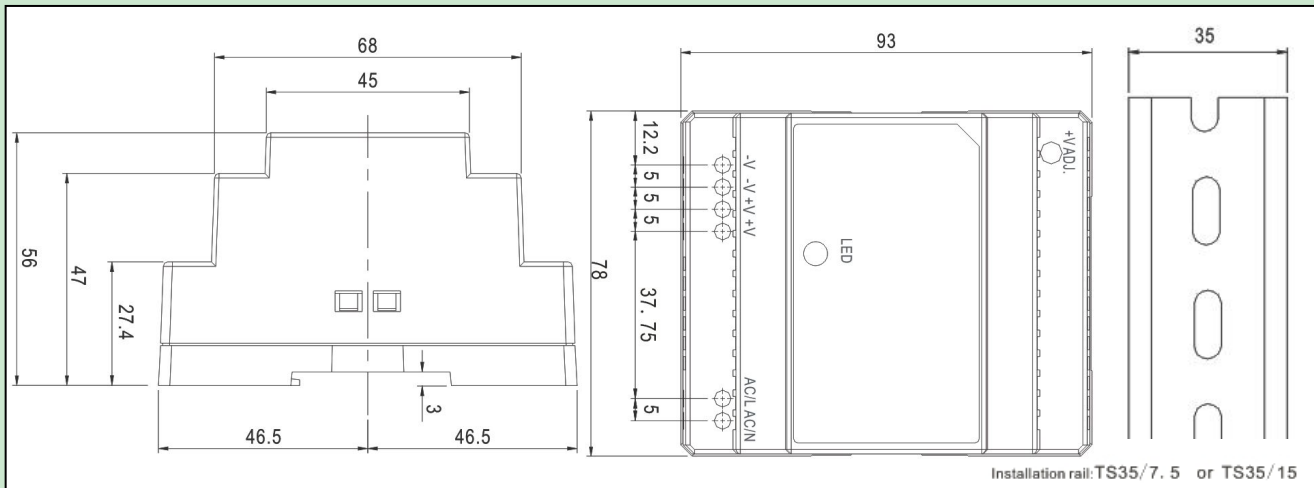

Installation rail: TS35/7.5 or TS35/15